

2 Digit 11.0 mm (.4") Series

Conventional Part No.	Global Part No.	Lighting Color
LN524YAMY	LNLM424AP01	Amber
LN524YKMY	LNLM424KP01	Amber
LN524OAMO	LNLM824AP01	Orange
LN524OKMO	LNLM824KP01	Orange

端子接続 Terminal Connection

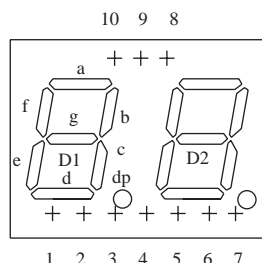

Pin No.	Assignment	Assignment
1	Cathode e	Anode e
2	Cathode d	Anode d
3	Cathode c	Anode c
4	Cathode dp	Anode dp
5	Cathode b	Anode b
6	Cathode a	Anode a
7	Cathode g	Anode g
8	Cathode f	Anode f
9	Common Anode D2	Common Cathode D2
10	Common Anode D1	Common Cathode D1

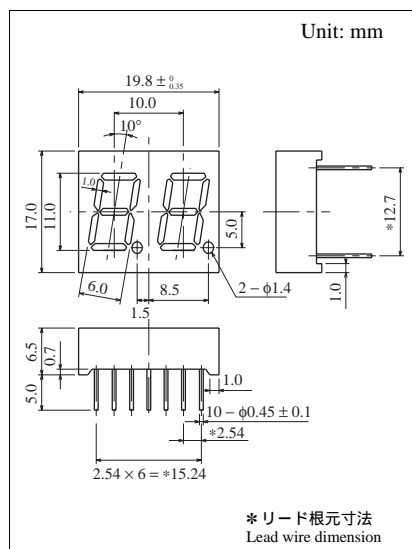

■ 絶対最大定格 Absolute Maximum Ratings ($T_a = 25^\circ\text{C}$)

Lighting Color	$P_D(\text{mW})$	$I_F(\text{mA})$	$I_{FP}(\text{mA})^*$	$V_R(\text{V})$	$T_{opr}(\text{C})$	$T_{stg}(\text{C})$
Amber	60	15	100	5	$-25 \sim +80$	$-30 \sim +85$
Orange	60	15	100	3	$-25 \sim +80$	$-30 \sim +85$

I_{FP} の条件は $\text{duty } 10\%$ $\text{Pulse width } 1 \text{ msec}$. The condition of I_{FP} is $\text{duty } 10\%$, $\text{Pulse width } 1 \text{ msec}$

■ 電気的光学的特性 Electro-Optical Characteristics ($T_a = 25^\circ\text{C}$)

Conventional Part No.	Lighting Color	Common	I_O / seg		$I_O / \text{d.p.}$		V_F		λ_P	$\Delta\lambda$	I_F	I_R	
			Typ	Min	Typ	I_F	Typ	Max				Max	V_R
LN524OAMO	Orange	Anode	600	200	200	10	2.00	2.8	590	30	10	10	5
LN524YKMY	Amber	Cathode	600	200	200	10	2.00	2.8	590	30	10	10	5
LN524OAMO	Orange	Anode	1200	300	500	10	1.93	2.8	630	40	10	10	3
LN524OKMO	Orange	Cathode	1200	300	500	10	1.93	2.8	630	40	10	10	3
Unit	—	—	μcd	μcd	μcd	mA	V	V	nm	nm	mA	μA	V

