

200 V - 1,000 V Single Phase Bridge
12.0 A Forward Current
70 ns - 3000 ns Recovery Time

1402 - 1410
1402F - 1410F
1402UF - 1410UF

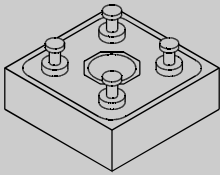

ELECTRICAL CHARACTERISTICS AND MAXIMUM RATINGS

Part Number	Working Reverse Voltage (V _{rw})	Average Rectified Current @TC (I _o)		Reverse Current @ V _{rw} m (I _r)		Forward Voltage (V _f)		1 Cycle Surge Current t _p =8.3ms (I _{fsm})	Repetitive Surge Current (I _{frm})	Reverse Recovery Time (1) (T _{rr})	Thermal Impd. θ _{J-C}
		55°C	100°C	25°C	100°C	25°C		25°C	25°C	25°C	
	Volts	Amps	Amps	µA	µA	Volts	Amps	Amps	Amps	ns	°C/W
1402	200	12.0	9.0	1.0	25	1.1	3.0	150	25	3000	3.2
1406	600	12.0	9.0	1.0	25	1.1	3.0	150	25	3000	3.2
1410	1000	12.0	9.0	1.0	25	1.1	3.0	150	25	3000	3.2
1402F	200	12.0	9.0	1.0	25	1.2	3.0	100	20	150	3.2
1406F	600	12.0	9.0	1.0	25	1.5	3.0	100	20	150	3.2
1410F	1000	12.0	9.0	1.0	25	1.5	3.0	100	20	150	3.2
1402UF	200	12.0	9.0	1.0	25	1.7	3.0	100	20	70	3.2
1406UF	600	12.0	9.0	1.0	25	1.7	3.0	100	20	70	3.2
1410UF	1000	12.0	9.0	1.0	25	1.7	3.0	100	20	70	3.2

(1)Trr Testing: If=0.5A, Ir=1.0A, Irr=0.25A *Op. Temp. & Stg. Temp. = -55°C to +150°C Isolation Voltage: 1500V

10

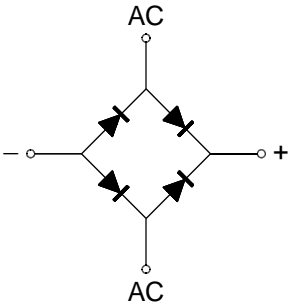
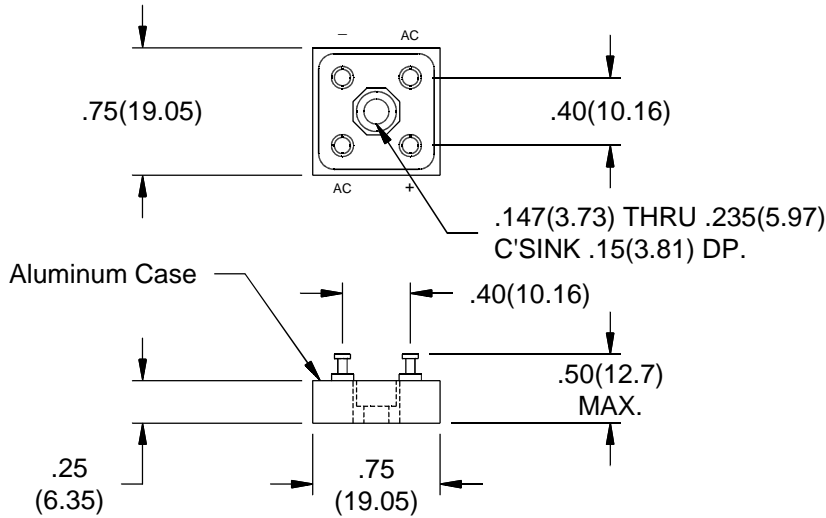

Dimensions: In. (mm) • All temperatures are ambient unless otherwise noted. • Data subject to change without notice.



VOLTAGE MULTIPLIERS INC.
8711 W. Roosevelt Ave.
Visalia, CA 93291

TEL 559-651-1402
FAX 559-651-0740
www.voltagemultipliers.com

1402 - 1410 • 1402F - 1410F • 1402UF - 1410UF

