



## Silicon Bridge Rectifiers

2W005--2W10

### FEATURES

- Rating to 1000V PRV
- Surge overload rating to 50 Amperes peak
- Ideal for printed circuit board
- Reliable low cost construction utilizing molded plastic technique results in inexpensive product
- Surge overload rating to 50 Amperes peak 94V-O
- Glass passivated chip junctions



Lead-free

### Maximum Ratings (@T<sub>A</sub> = 25°C unless otherwise specified)

Characteristic	Symbol	2W005	2W01	2W02	2W04	2W06	2W08	2W10	UNITS
Maximum recurrent peak reverse voltage	V <sub>RRM</sub>	50	100	200	400	600	800	1000	V
Maximum RMS voltage	V <sub>RMS</sub>	35	70	140	280	420	560	700	V
Maximum DC blocking voltage	V <sub>DC</sub>	50	100	200	400	600	800	1000	V
Maximum average forward Output current @T <sub>A</sub> =25°C	I <sub>F(AV)</sub>	2.0							A
Peak forward surge current 8.3ms single half-sine-wave superimposed on rated load	I <sub>FSM</sub>	50.0							A

### Thermal Characteristics

Characteristic	Symbol	2W005	2W01	2W02	2W04	2W06	2W08	2W10	UNITS
Operating junction temperature range	T <sub>J</sub>	- 55 ---- + 125							°C
Storage temperature range	T <sub>STG</sub>	- 55 ---- + 150							°C

### Electrical Characteristics (@T<sub>A</sub> = 25°C unless otherwise specified)

Characteristic	Symbol	2W005	2W01	2W02	2W04	2W06	2W08	2W10	UNITS
Maximum instantaneous forward voltage @1.0A	V <sub>F</sub>	1.1							V
Maximum reverse current @T <sub>A</sub> =25°C at rated DC blocking voltage @T <sub>A</sub> =100°C	I <sub>R</sub>	5.0 0.5							μ A m A

## Silicon Bridge Rectifiers

**2W005--2W10**

### PACKAGE OUTLINE DIMENSIONS

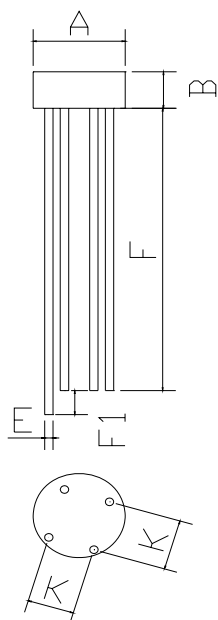

WOM		
Dim	Min	Max
A	Ø 8.70	Ø 9.10
B	5.00	5.60
E	Ø0.60	Ø0.80
F	23.0min (长) \18.50min (短)	
F1	2.0min	
K	4.70	5.30
All Dimensions in mm		

### PACKAGE INFORMATION

Device	Package	Shipping
2W005--2W10	WOM	1000Units/Box

## Silicon Bridge Rectifiers

2W005--2W10

FIG.1 -- PEAK FORWARD SURGE CURRENT

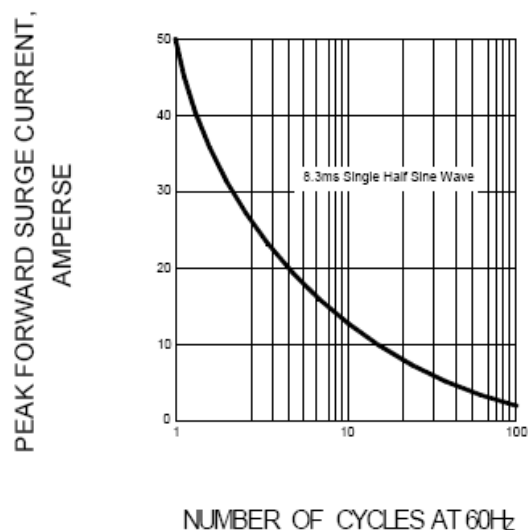

FIG.2 -- FORWARD DERATING CURVE  
OUTPUT RECTIFIED CURRENT

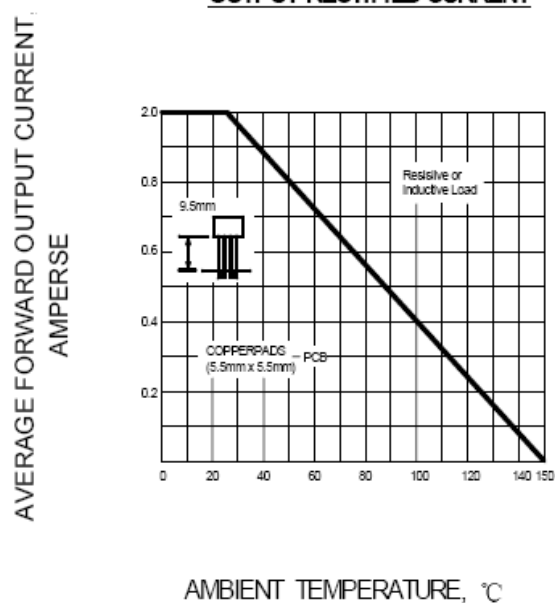

FIG.3 -- TYPICAL FORWARD CHARACTERISTIC

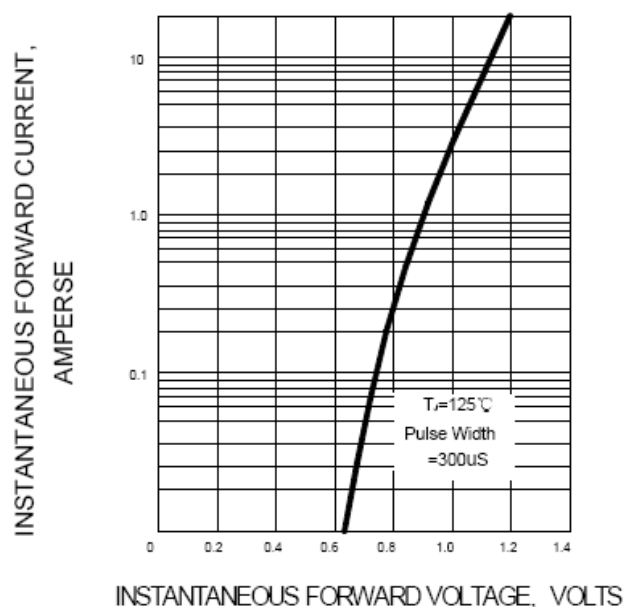

FIG.4 -- TYPICAL REVERSE CHARACTERISTIC

